



constructive solutions

FLOORING PRODUCT

NITOFLOR® PA

**Two component solvent-free polyaspartic coating.
Available as a clear coating and in a range of 8 colours.**

Ideal as a UV and abrasion resistant top coat for resin floor systems such as epoxy and polyurethane cement, or as a stand alone coating over correctly prepared concrete surfaces.

ADVANTAGES

- Solvent free, 100% solids
- Suitable for interior and exterior applications
- Fast return to service – accepts foot traffic after 2 hours, light vehicle traffic after 24 hours*
- UV resistant and colour fast**
- Abrasion and scratch resistant
- High wear resistance - withstands constant traffic
- Good chemical resistance
- Suitable for new and existing floors



TYPICAL APPLICATIONS:

Use in food and chemical industries, hospitals, schools, kitchens and other high traffic applications.

*At temperatures of 20 - 30°C, in cold weather a longer period before use may be required.

**Nitoflor PA is UV resistant and colour fast but applying the clear coating over a non-UV resistant coating, such as epoxy, will not stop the epoxy from fading or discolouring under the clear coating.

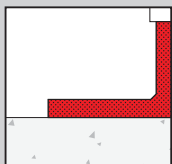

Industrial Flooring

For further information on our industrial flooring range visit www.fosroc.com.au or fosroc.co.nz
Always refer to the product TDS before making your final selection or speak to your Fosroc representative.

Nitoflor[®] PA

Design Criteria

Nitoflor PA is designed for application on floors in two coats at between 80 and 200 microns wet film thickness per coat depending on the application.

Substrates should be dry and not suffer, or be likely to suffer, from rising damp. Substrates should have a moisture content not greater than 4% at the time of installation (refer Limitations section on the TDS).

Curing Times

Drying time is temperature, humidity and film thickness dependent. Thicker films will take longer to through-cure. High humidity will shorten cure time. The following cure times were obtained in controlled laboratory conditions 25°C and 35% relative humidity with a WFT of 0.1mm.

Tack free time:	1.5 hours
Foot traffic:	2 to 2.5 hours
Recoat time:	1.5 to 2 hours (min) 18 hours (max)
Cure time (vehicle traffic):	24 hours

Coverage

Depending on application and surface condition:
5 to 12.5m² /litre per coat on concrete.

The coverage figures given are theoretical due to wastage factors and the variety and nature of possible substrates, practical coverage figures will be reduced.

Properties

The following results were obtained in controlled laboratory conditions 25°C and 50% relative humidity.

Solids content:	100%
VOC Content	79 g/litre
Working-life time @20-25°C:	40 minutes (after mixing)#
Dry film thickness on floors (2 coats):	160-400 microns
Hardness AS1683.15.2:	95 Shore A 53 Shore D
Tensile strength AS1683.11:	12 MPa
Elongation AS1683.11:	47%
Tear strength AS1683.12:	56 kN/m
Abrasion resistance AS1580.403.2, CS17, 1000 cycles:	47.8 mg loss

Working-life time will be reduced if product is kept in can after mixing. Once mixed the product should be poured out in ribbons onto the floor and rolled out immediately.

Chemical Resistance

Nitoflor PA is resistant to many other common industrial chemicals. Please contact Fosroc for specific details.

Common organic solvents	Good resistance
Petroleum based solvents	Good resistance
Bleach	Good resistance

Adhesion Properties

Nitoflor PA has been tested for adhesion to the following typical flooring base materials.

Base material	Bond strength
Nitoflor FC150 HP	>3MPa
Nitoflor PU600	>3MPa

Nitoflor PA should be applied within 48 hours of application of the base materials.

Always refer to the product TDS before making your final selection or speak to your Fosroc representative.

Product Application

Nitoflor PA can be used as a top coat over existing resin floor systems such as epoxy and polyurethane cement to provide UV resistance, enhanced abrasion resistance or provide colour options.

Nitoflor PA is compatible as a top coat with the Fosroc products in the following table.

Technology	Product	Description
Epoxy	Nitoflor FC150 HP	Heavy duty, solvent free, low VOC, high build epoxy coating. Highly resistant to industrial chemicals and forklift/commercial type traffic.
	Nitoflor FC150 HP-FC	Rapid cure, heavy duty, solvent free, low VOC, high build epoxy coating. Highly resistant to industrial chemicals and forklift/commercial type traffic.
	Nitoflor SL	Solvent free, low VOC, self smoothing epoxy floor topping. Apply from 2 to 4mm, produces an impervious, chemical resistant finish which is hygienic and easy to clean.
	Nitoflor SLX	Cold temperature application, solvent free, low VOC, self smoothing epoxy floor topping. Apply from 2 to 4mm, produces an impervious, chemical resistant finish which is hygienic and easy to clean.
	Nitoflor N	Two part solvent free novolac epoxy floor coating for areas where aggressive chemical spills occur and high wear resistance is required. Add Nitomortar F4 fillers for a 5mm trowel finish.
Polyurethane cement	Nitoflor PU200	Low odour, low VOC cementitious polyurethane floor sealer with anti-microbial properties. Produces a hardwearing, chemically resistant floor that can handle extreme temperatures.
	Nitoflor PU600	Nitoflor PU600 must be used with Nitoflor PU200. Low odour, low VOC cementitious polyurethane floor topping with anti-microbial properties. Produces a hard-wearing, chemically resistant floor that can handle extreme temperatures.

The diagram below shows the recommended application system for flooring with added slip resistance.

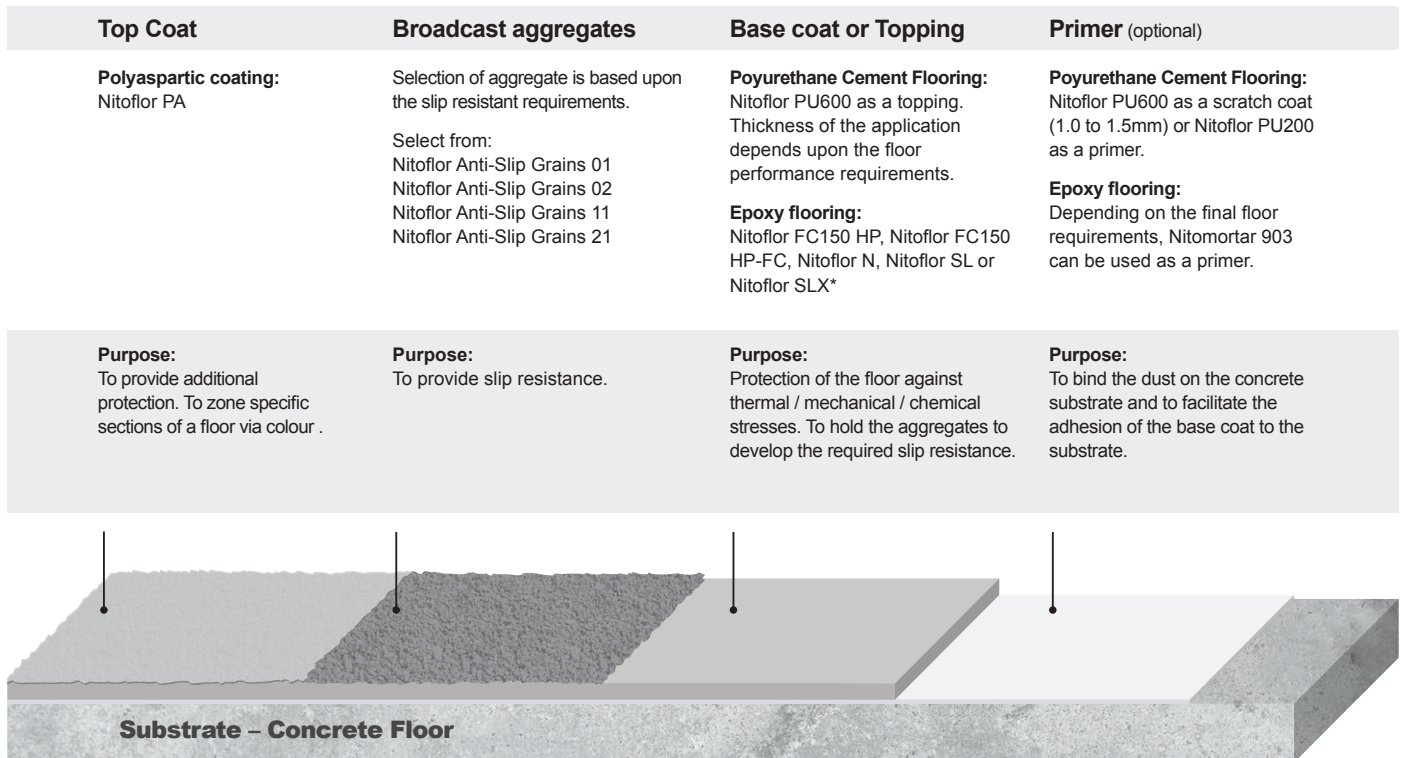

Note - diagram is for illustrative purposes only, final texture and appearance of the floor may differ. For details on the different applications, instructions and limitations, please refer to the Technical Data Sheet or contact your local Fosroc Representative.

*Aggregates cannot be applied directly on to Nitoflor SL or Nitoflor SLX. They must be cured first, then Nitoflor FC150 HP or Nitoflor FC150 HP-FC applied on top followed by the broadcast grains.

Colour Chart*

Nitoflor PA is available as a clear coating and in a range of 8 colours, including 6 Australian Standard colours.



BRIGHT BLUE B23



JADE G21



SIGNAL RED R13



SUNFLOWER Y15



OATMEAL Y54 MTO



PIPELINE GREY N43 (MTO 40L KIT)



CURTAIN CALL MTO

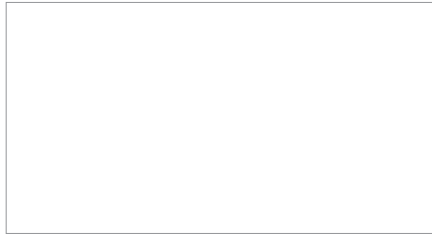

WHITE

Supply

8L KIT

Code	Description	Size	Colour
FC605050-4L	Nitoflor PA Part A	4L	Clear
FC605051-4L	Nitoflor PA Part B	4L	Clear
FC605055-4L	Nitoflor PA Part B	4L	Bright Blue B23
FC605053-4L	Nitoflor PA Part B	4L	Curtain Call MTO
FC605056-4L	Nitoflor PA Part B	4L	Jade G21
FC605058-4L	Nitoflor PA Part B	4L	Oatmeal Y54 MTO
FC605052-4L	Nitoflor PA Part B	4L	Pipeline Grey N43
FC605054-4L	Nitoflor PA Part B	4L	Signal Red R13
FC605057-4L	Nitoflor PA Part B	4L	Sunflower Y15
FC605059-4L	Nitoflor PA Part B	4L	White

40L KIT

Code	Description	Size	Colour
FC605050-20L	Nitoflor PA Part A	20L	Clear
FC605051-20L	Nitoflor PA Part B	20L	Clear
FC605055-20L	Nitoflor PA Part B	20L	Bright Blue B23 MTO
FC605053-20L	Nitoflor PA Part B	20L	Curtain Call MTO
FC605056-20L	Nitoflor PA Part B	20L	Jade G21 MTO
FC605058-20L	Nitoflor PA Part B	20L	Oatmeal Y54 MTO
FC605052-20L	Nitoflor PA Part B	20L	Pipeline Grey N43 MTO
FC605054-20L	Nitoflor PA Part B	20L	Signal Red R13 MTO
FC605057-20L	Nitoflor PA Part B	20L	Sunflower Y15 MTO
FC605059-20L	Nitoflor PA Part B	20L	White MTO

Please note, most colours are Made-to-Order (MTO). Made-to-Order (MTO) colours need to be ordered by contacting Customer Service or your Fosroc representative.

Minimum Order Quantities (MOQ), Order Quantity Breaks and Lead Times apply.

*Colours shown are as close as possible to actual colours. Please note due to limitations of the printing process, photographic and printed images may not represent the true colour.

AU 1800 812 864

fosroc.com.au

NZ 0800 657 156

fosroc.co.nz

Parchem Construction Supplies Pty Ltd

1956 Dandenong Rd, Clayton VIC AUS 3168

Distributed in New Zealand by Concrete Plus Ltd

150 Hutt Park Road, Gracefield NZ 5010

Fosroc, the Fosroc logo and Nitoflor are trade marks of Fosroc International Limited, used under licence.